

1 Choose a Location for Your Radio and Mount It

Install the Dash or Window Mount

Before you begin, you may want to have the User Guide for your XM onyx Radio handy, as there are a couple of steps where we suggest you reference it. If you do not have the User Guide, go to xmradio.com, click on **SHOP**, then click on your onyx, and then click **SUPPORT**. Click on the **User Guide** link.

You can use either the Dash Mount or the Window Mount for your radio, depending upon your vehicle and the location where you want to place your radio.

- CAUTION!** Make sure your radio isn't in a place where it could interfere with driver visibility or safe deployment of the airbags. Airbag locations are typically marked with "SRS" logos.
- IMPORTANT!** When you install the chosen mount, do not yet attach the PowerConnect Vehicle Dock to the mount. The cables must be attached prior to connecting the dock to the mount.

Installing the Dash Mount:

- CAUTION:** The adhesive used on the Dash Mount may be difficult to remove. Do not install this mount on leather surfaces (contact your automobile dealership if you are unsure about your dash surface), and make sure the air temperature is at least 60° F (15° C) during installation. If it's not at least 60° F, turn on the heater in your vehicle to bring the temperature up to 60° F.

- 1 Locate a flat surface for the Dash Mount. Make sure there is ample room for the PowerConnect Vehicle Dock and radio when installed.
- 2 Set the orientation of the Dash Mount before adhering to it. Loosen the knob and adjust the adhesive foot for the location you selected:

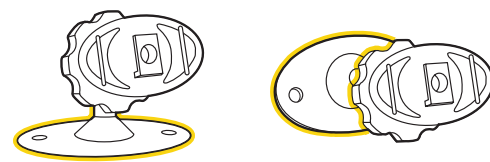

DASH MOUNT - Option 1 & DASH MOUNT - Option 2 should be oriented like the image above. DASH MOUNT - Option 3 should be oriented like the image above.

DASH MOUNT - Options 1 & 3

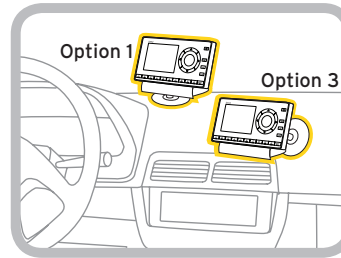

DASH MOUNT - Option 2

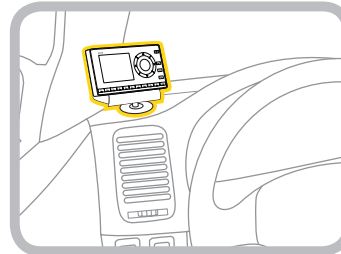

Pick a Spot for Your Radio (continued)

- 3 The dock mounting plate can be tilted in different directions. Adjust as necessary for your particular vehicle. When the orientation is correct, tighten the knob.

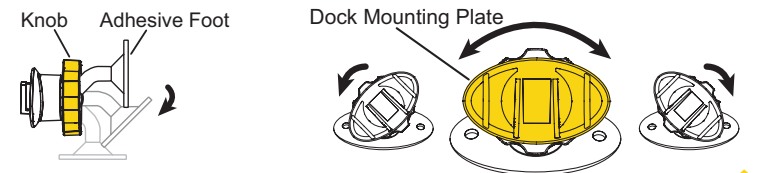

- 4 Clean the surface with the alcohol preparation pad, and let it dry thoroughly.

- 5 Peel off the adhesive liner. Position, press, and hold the Dash Mount in place for 30 seconds.

- IMPORTANT!** Allow the Dash Mount adhesive to cure (dry) for at least 24 hours before using the mount.

Installing the Window Mount:

- IMPORTANT!** States or localities may prohibit driving with a suction mount on the windshield. (See California Vehicle Code Section 26708(a); Minnesota Statutes 2008, Section 169.71). When driving in these areas, the dash mounting option should be used instead. Check your state or local laws for any applicable restrictions. SIRIUS XM Radio Inc. does not take any responsibility for any fines, penalties or damages that may be incurred as a result of disregarding this notice.

- 1 Locate a place on the windshield for the mount. Make sure there is ample room for the PowerConnect Vehicle Dock and radio when installed, and that it does not block the driver's vision or any airbag. (Airbag locations are typically marked with "SRS" logos.)

WINDOW MOUNT - Option 1

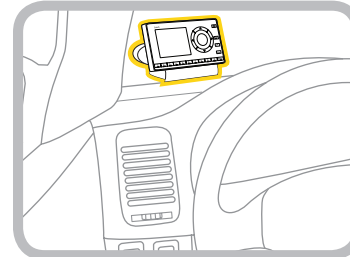

WINDOW MOUNT - Option 2

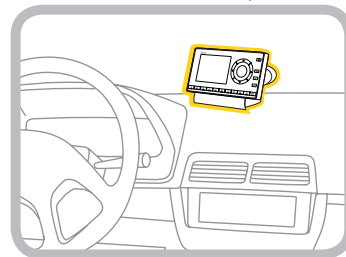

Pick a Spot for Your Radio (continued)

- 2 Clean the surface with the alcohol preparation pad and let it dry thoroughly.

- 3 Press and hold the mount against the windshield. Then press the lever all the way down to attach the Window Mount to the windshield.

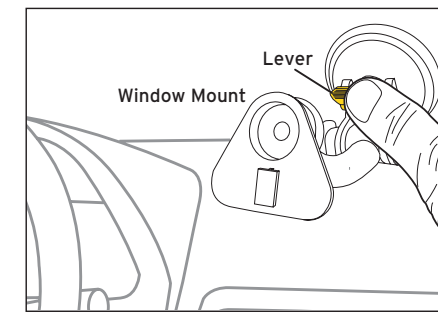

- 4 Loosen the knob on the Window Mount to adjust the height of the radio for the best view. Once the height is correct, tighten the knob. The dock mounting plate can be swiveled to the left or right, and adjusted up or down, to optimize the driver's view of the radio.

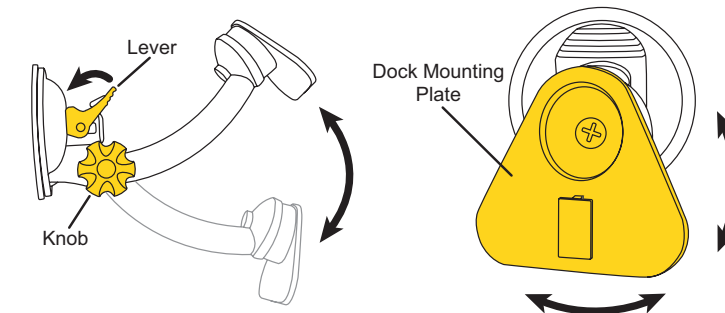

2 Install the Magnetic Mount Antenna

Mount the Magnetic Mount Antenna

- 1 Choose the best location for the Magnetic Mount Antenna considering your vehicle type. More detailed information on this can be found in the User Guide beginning on page 20.

- **Sedan or Coupe:** We recommend mounting the antenna just above either the front windshield or the back window.
- **Pickup Truck:** We recommend mounting the antenna just above the front windshield.
- **Convertible:** We recommend mounting the antenna at the leading edge of the trunk.
- **SUV:** We recommend mounting the antenna at the rear of the roof.

- CAUTION! STOP** and read the more specific instructions in the User Guide for all types of vehicles – or get someone who knows vehicles to help – if you don't understand what to do. You might accidentally do damage to your ride.

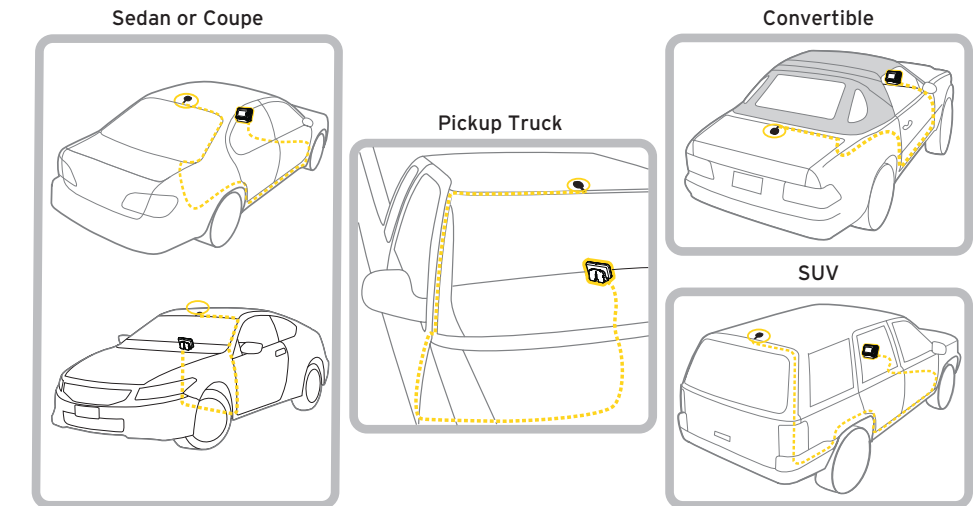

- 2 Clean the surface of the selected mounting location using the alcohol preparation pad and let it dry thoroughly and place the antenna in the location you selected.

Install the Magnetic Mount Antenna (continued)

- 3 Feed the antenna wire under the rubber molding around the front or rear windshield, and into the seal around the trunk or door. For a convertible, the cable can be routed directly into the trunk.

- TIP!** Use a tool like a blunt plastic putty knife, a credit card, a plastic knife, or a similar blunt tool to help hide wires along the windshield trim and interior trim.

Hide the Magnetic Mount Antenna Cable Inside the Vehicle

The best place to hide your antenna cable depends on your type of vehicle.

When the antenna is mounted at the rear of the vehicle, it's usually easiest to run the cable from the rear to the front toward the radio by routing the cable along the interior trim where it meets the carpet, gently pushing it behind the edges of the trim. Bring the cable out from the trim and route it under the carpet toward the dashboard.

When the antenna is mounted at the front of the vehicle, bring the cable into the rubber weather stripping around the door to the bottom of the door opening. Bring the cable out of the weather stripping and route it under the carpet toward the dashboard.

Coil any excess cable in a hidden location, such as under the carpet, keeping it away from any vehicle pedals or controls. Secure the excess cable with wire ties.

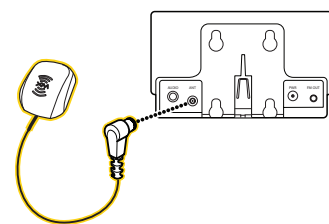

Plug the antenna into the **silver ANT** connection on the rear of the dock.

- TIP!** A dry vehicle is nice. Avoid damaging or compromising the window, door, and trunk seals as you route the cable.

- TIP!** For more help, refer to the detailed antenna cable routing instructions for your type of vehicle, in the User Guide beginning on page 25.

3 Connect the PowerConnect Adapter and Dock

Connect the PowerConnect Power Adapter

Insert the PowerConnect Power Adapter into your vehicle's cigarette lighter or power adapter socket. Then plug it into the **red PWR** connector on the rear of the dock. Use only the provided PowerConnect Power Adapter.

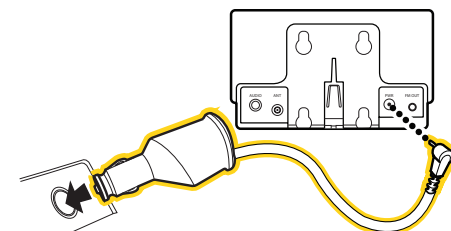

Attach the Dock to the Mount and the Radio to the Dock

Attach the PowerConnect Vehicle Dock to the mount that you selected. Utilize the wire guide at the rear of the dock to help organize the wire and cables, and make your installation neater. Place your radio into the dock. Press the **Power** button to turn it on.

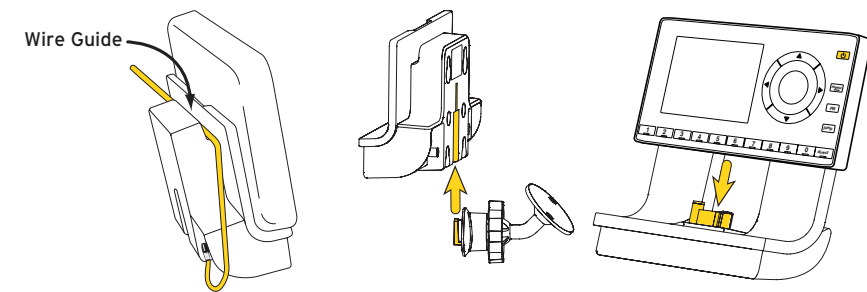

4 Connect the Audio to Your Vehicle's Stereo

Choose and Setup Your Audio Connection Option

Connect your radio to play the audio through your vehicle's stereo system or FM radio using one of the following options:

Audio Quality	GOOD	BETTER	BEST
FM Direct Adapter (FMDA)			★
Aux In Cable			★
Cassette Adapter		★	
PowerConnect	★		

- **Best:** Use the included **Aux In Cable** if your vehicle's stereo system has an auxiliary input connection. Plug one end of the cable into the **green AUDIO** connector on the PowerConnect Vehicle Dock and the other end into the vehicle stereo system's auxiliary input jack. Set the stereo system to play from the auxiliary input source.

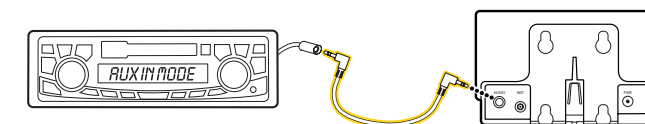

- **Better:** Use a **Cassette Adapter** if your vehicle has a built-in cassette player. Cassette Adapters are sold separately. Plug the Cassette Adapter into the **green AUDIO** connector on the PowerConnect Vehicle Dock. Insert the Cassette Adapter into the vehicle's cassette deck. Set the stereo system to play from the cassette source.

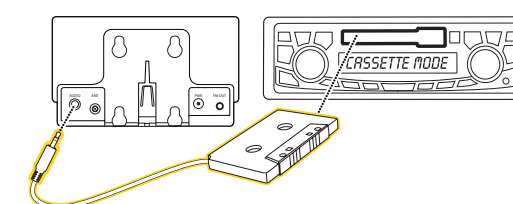

- **Good:** Use the **PowerConnect** feature in your radio. PowerConnect plays the audio through your vehicle's FM radio. When you have finished step 4, you'll first need to find an available FM channel, and then you'll need to ensure that the Satellite Radio and your vehicle's FM radio are tuned to the same available FM channel. (Step 5)

- **Best:** Use an **FM Direct Adapter**. Use an **FM Direct Adapter (FMDA)** if none of the above three audio connection options works in your vehicle. The FMDA needs to be installed by a professional installer and directly connects the radio to your vehicle's FM radio.

- TIP!** Refer to your vehicle's owners manual to find the location of the auxiliary input jack, or consult the vehicle dealer. To learn more about purchasing a Cassette Adapter or FMDA, check with the retailer where you bought your radio or go to xmradio.com/accessories.

If you connected the audio using the **AUX In Cable** or a **Cassette Adapter**, the installation is complete. Now sit back and enjoy Satellite Radio.

If you are connecting the audio using **PowerConnect**, continue with step 5.

5 PowerConnect

Tune your Radio and Vehicle FM Radio to the Same FM Channel

- 1 Find an Available FM Channel in Your Area

An available FM channel is one that's not being used by an FM radio station in your area. When you tune your FM radio to an available channel, you should only hear static or silence – not talk or music. We recommend one of the following methods to find an available FM channel:

- a Use the SIRIUS | XM FM Channel Finder at www.xmradio.com/fmchannel. Go to the website and enter your zip code. The Channel Finder will suggest a list of available FM channels in your area. For convenience, write down or print out the list.

OR

- b Manually tune through your local FM channels on your vehicle's FM radio. Turn on your vehicle's FM radio. Start at 88.1 and use the 'Manual' tune function on your vehicle's FM radio to tune through each FM channel one-by-one (88.1 followed by 88.3 etc.) to locate channels that aren't being used by a local FM radio station. Write down each FM channel that has only static or silence on it, until you reach 107.9. Once you have created your list of available FM channels, you will need to find the one that provides the best match for your Satellite Radio.

- 2 Tune your Vehicle's FM Radio

- a Pick the first FM channel on your list.
- b Turn on your vehicle's FM radio (if you have not already done so) and tune it to this FM channel.

- 3 Set Your Satellite Radio to Transmit on the Same FM Channel

- a Refer to the User Guide which accompanied your Satellite Radio, and turn On the FM Transmitter in your radio.
- b Refer to the User Guide again, and set your Satellite Radio to transmit on the same usable FM channel that you found in step 1.
- c Tune your Satellite Radio to a favorite XM channel (or channel 1 if it's not yet activated).
- d You should hear the XM audio through your vehicle's FM radio. If you are satisfied with the sound quality, you're done! Now sit back and enjoy Satellite Radio.

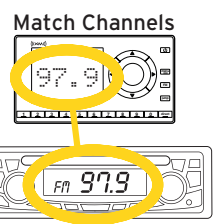

- If the selected FM channel doesn't work well for you, work down the list of FM channels until you find one that allows you to hear XM clearly. Each time, you will need to tune your vehicle's FM radio to the FM channel and then set your Satellite Radio to transmit on the same FM channel.

PowerConnect Vehicle Dock

Color-Coded Connections

The color-coded *PowerConnect* Vehicle Dock makes it simple to connect, just match the colors on the cable ends to the colors on the dock to see what goes where.

Rear View

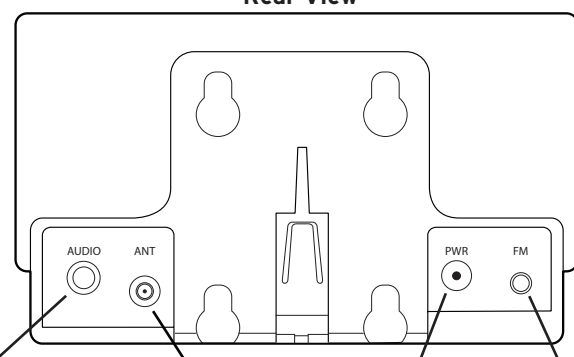

AUDIO (Green)
Connection for Aux In Cable or optional Cassette Adapter (sold separately).

ANT (Silver)
Connection for the Magnetic Mount Antenna.

PWR (Red)
Connection for *PowerConnect* Power Adapter.

FM (Blue)
Connection for optional FM Direct Adapter (sold separately).

xmradio.com

SIRIUS XM Radio Inc.
1221 Avenue of the Americas
New York, NY 10020

1.866.746.7691

© 2009 SIRIUS XM Radio Inc.

XM Dock & Play *PowerConnect*™ Second Vehicle Kit Quick Start Guide (XDPVKQSG0809) 100909a



Dock & Play Vehicle Kit Quick Start Guide



What's in the Box?

